

## KAN

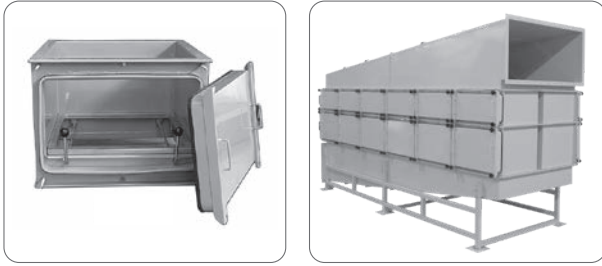

### Description

- KAN:** safety housing for special applications
- gas-tight casing in steel sheet th. 2 mm with epoxy coating
  - AISI 304 filter housing with fastening device that closes the eccentric linkages only if the filter is correctly seated
  - pre-configuration for barrier bag (not included) for safe replacement of filter
  - side door with knobs and sealing gasket with additional safety closing device only if the filter is correctly seated and installed
  - operation with working pressure of  $\pm 5000$  Pa
  - $\Delta p$  size fittings

### Accessories

- manifold fittings
- airtight damper EN 1751 CL4 or DIN 1946/4
- filter replacement bag (list price €80)
- pressure gauge
- depressurisation valve

### Special executions

- KAN..X: in AISI 304 stainless steel
- F6 F7 F8 filters multiple executions

### Double-face multiple executions

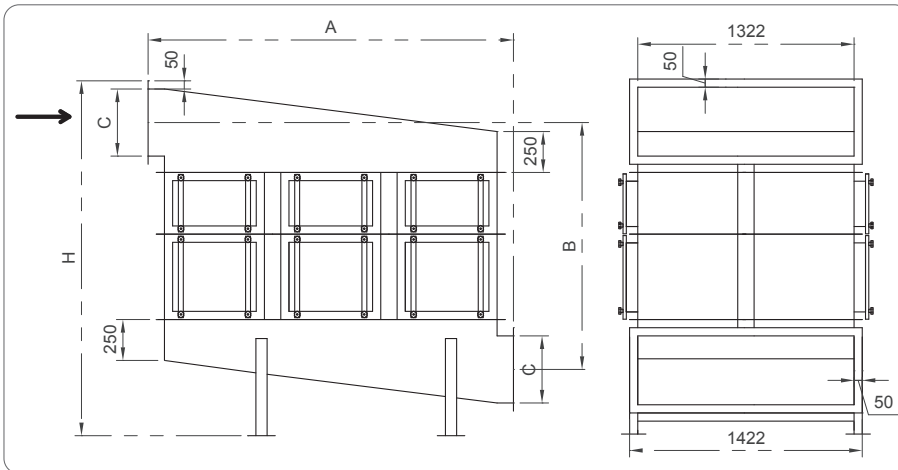

### Single-face executions

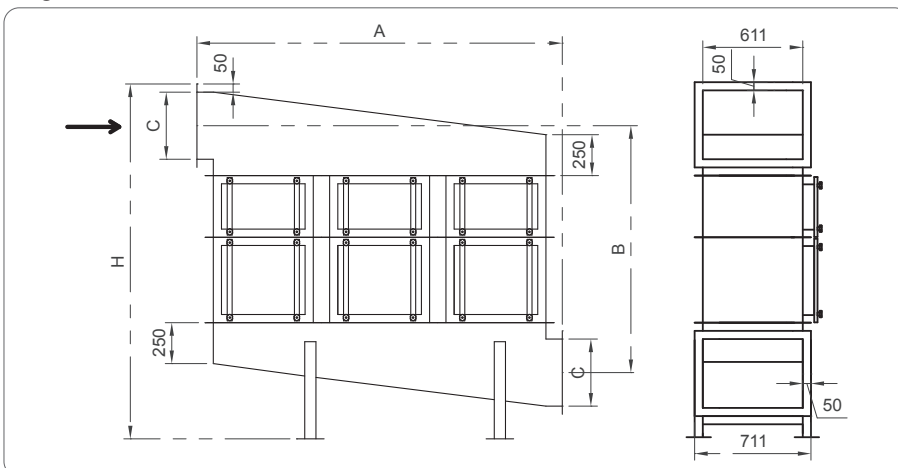

All prices are list prices for local market, for a quotation please contact us.

### Price list

GR/Type	Code	KAN	H13 FAT3	H14 FAT4	H13 FAD3	H14 FAD4
305x305x155	331	790	OR	OR	OR	OR
457x457x155	441	896	OR	OR	OR	OR
610x610x155	661	1055	OR	OR	OR	OR
305x305x292	332	838	OR	OR	OR	OR
457x457x292	442	979	OR	OR	OR	OR
610x610x292	662	1194	258	270	475	495

### Dimensions

Filter 292 mm	A (mm)	B (mm)	C (mm)
305x305	406	406	522
457x457	558	558	522
610x610	711	711	522

## KAN

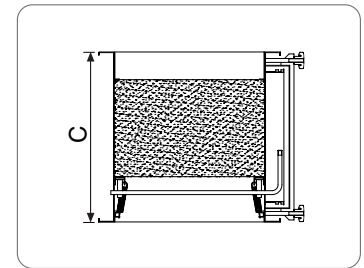
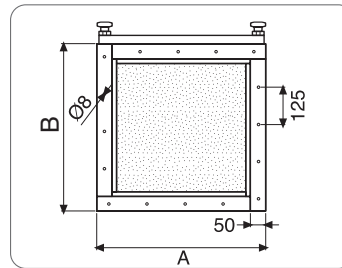

### Dimensions

ROWS	Measurements (mm)				Weight (Kg)
	A	B	C	H	
2	1522	1349	250	1849	315
3	2233	1499	400	2149	480
4	2944	1649	550	2449	675
5	3655	1649	550	2449	830
6	4366	1899	800	2949	1055
7	5077	1899	800	2949	1210
8	5788	1999	900	3149	1425

Prices on request

### Dimensions

ROWS	Measurements (mm)				Weight (Kg)
	A	B	C	H	
2	1522	1349	250	1849	660
3	2233	1499	400	2149	990
4	2944	1649	550	2449	1360
5	3655	1649	550	2449	1670
6	4366	1899	800	2949	2090
7	5077	1899	800	2949	2430
8	5788	1999	900	3149	2820

Prices on request

The executions shown refer to situations with double filtration stages, thickness 150 and 292